



Accessible Space, Inc.

2550 University Avenue West, Suite 330 N | St. Paul, Minnesota 55114

OUR MISSION HOUSING WITH CARE

The mission of Accessible Space, Inc. (ASI) is to provide accessible, affordable, assisted, supportive and independent living opportunities for persons with physical disabilities and brain injuries as well as seniors. This mission is accomplished through the development and cost-effective management of accessible, affordable housing, assisted/supportive/independent living and rehabilitation services.

ACKNOWLEDGEMENTS FUNDING AND SUPPORT

Accessible Space, Inc. (ASI) gratefully acknowledges the following organizations for their funding and/or support:

U.S. Department of Housing and Urban Development (HUD); Ramsey County CDBG and Endowment Funds; Minnesota Housing Finance Agency (MHFA); Federal Home Loan Bank of Des Moines' Affordable Housing Program; The Jay and Rose Phillips Family Foundation; F.R. Bigelow Foundation; The Saint Paul Foundation; and the Greater Twin Cities United Way.



Committed to the success of equal housing opportunities throughout the nation

ASI



Accessible Space, Inc. (ASI): Sponsor, Developer and Management Agent

ROSELAWN VILLAGE APARTMENTS ROSEVILLE, MINNESOTA

Accessible, Affordable Apartments For Adults With Qualifying Disabilities

1074 Roselawn Avenue West
Roseville, Minnesota 55113



Accessible Space, Inc.

HOUSING WITH CARE



ROSELAWN VILLAGE APARTMENTS ROSEVILLE, MINNESOTA

Accessible, Affordable Apartments For Adults With Qualifying Disabilities

AFFORDABLE

- Qualifying households pay 30% of adjusted gross monthly income for rent
- Rent is subsidized by the U.S. Department of Housing and Urban Development (HUD)-Income limits apply
- Rent includes: Heat, water, sewer, trash & snow removal

BASIC QUALIFICATIONS

- One household member must have a qualifying disability
- Applicants are screened for credit, rental and criminal history
- Households must be income qualified (income limits apply and security deposit required)

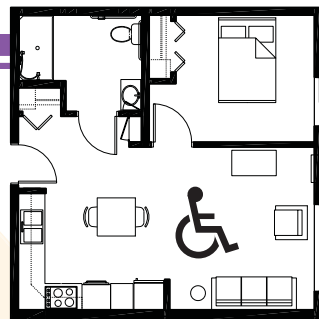
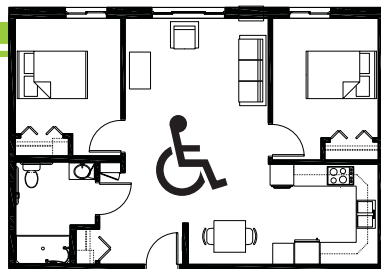

APARTMENT FEATURES

- 22 accessible, one and two bedroom apartments
- Spacious, accessible kitchens
- Large accessible bathrooms
- Generous closet & storage space
- Carpeted bedrooms and living room
- Window blinds

BUILDING FEATURES

- Open entry & lobby
- Controlled access, hands free entry system
- Elevator service
- Large community room, library and lounge
- On-site laundry facilities
- Approved pets welcome! (with deposit)
- Trash chutes on each floor

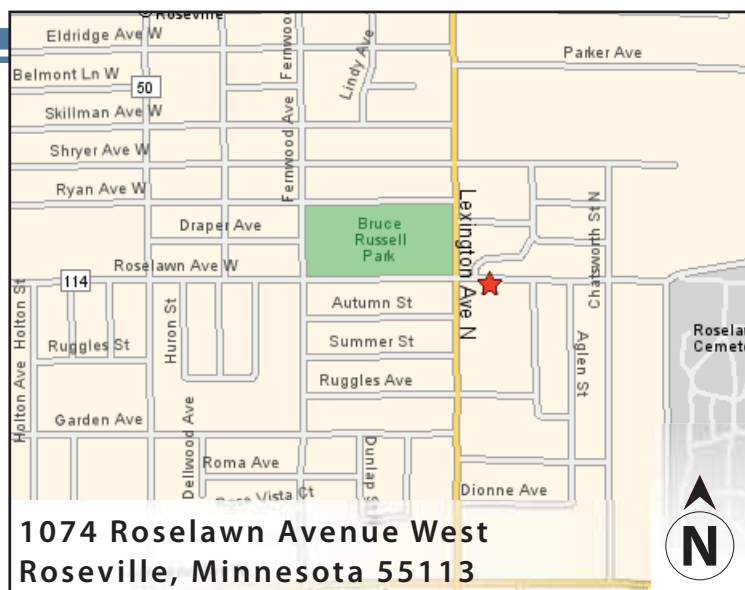

CONVENIENT NEIGHBORHOOD LOCATION

- Grocery stores, shopping & restaurants
- Banking Services
- Hospitals, medical & professional clinics
- Churches

For more information or to request a housing application, please call

- toll-free 1-800-466-7722
- tty/tdd 1-800-627-3529

Apply online www.accessiblespace.org

Accessible Space, Inc. (ASI)

2550 University Avenue West, Suite 330 North
Saint Paul, Minnesota 55114

