



# Accessible Space, Inc.

2550 University Avenue West, Suite 330 N | St. Paul, Minnesota 55114

## OUR MISSION HOUSING WITH CARE

The mission of Accessible Space, Inc. (ASI) is to provide accessible, affordable, assisted, supportive and independent living opportunities for persons with physical disabilities and brain injuries as well as seniors. This mission is accomplished through the development and cost-effective management of accessible, affordable housing, assisted/supportive/independent living and rehabilitation services.

## ACKNOWLEDGEMENTS FUNDING AND SUPPORT

Accessible Space, Inc. (ASI) gratefully acknowledges the following organizations for their funding and/or support:

The U.S. Department of Housing and Urban Development (HUD); The Alabama Head Injury Foundation (AHIF); Shoals Adult Cerebral Palsy Group; The City of Florence, Alabama; The Alabama Head Injury Foundation/Shoals Support Group; The Federal Home Loan Bank of Atlanta-Affordable Housing Program/Am South Bank.



Committed to the success of equal housing opportunities throughout the nation

ASI

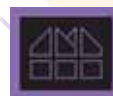

Accessible Space, Inc. (ASI):  
Sponsor, Developer and  
Management Agent

## DOGWOOD TERRACE FLORENCE, ALABAMA



***Accessible, Affordable Apartments For  
Adults With Qualifying Disabilities***

1502 Marlborough Boulevard  
Florence, Alabama 35630



**Accessible Space, Inc.**

HOUSING WITH CARE

# AccessibleSpace, Inc.

## DOGWOOD TERRACE FLORENCE, ALABAMA

*Accessible, Affordable Apartments For Adults With Qualifying Disabilities*

### AFFORDABLE

- Qualifying households pay 30% of adjusted gross monthly income for rent
- Rent is subsidized by the U.S. Department of Housing and Urban Development (HUD)-Income limits apply
- Rent includes: Heat, water, sewer, trash & snow removal

### BASIC QUALIFICATIONS

- One household member must have a qualifying disability
- Applicants are screened for credit, rental and criminal history
- Households must be income qualified (income limits apply and security deposit required)

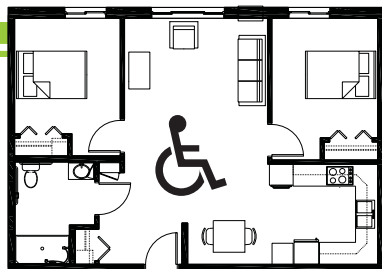

### APARTMENT FEATURES

- 20 accessible, one and two bedroom apartments
- Spacious accessible kitchens
- Large accessible bathrooms
- Roll-in showers
- Level-action door handles
- Raised electrical outlets, lowered light switches

### BUILDING FEATURES

- Controlled access entry system
- On-site laundry facilities
- Outdoor patio with covered porch
- Large community room
- Approved pets welcome!
- Parlor/Library

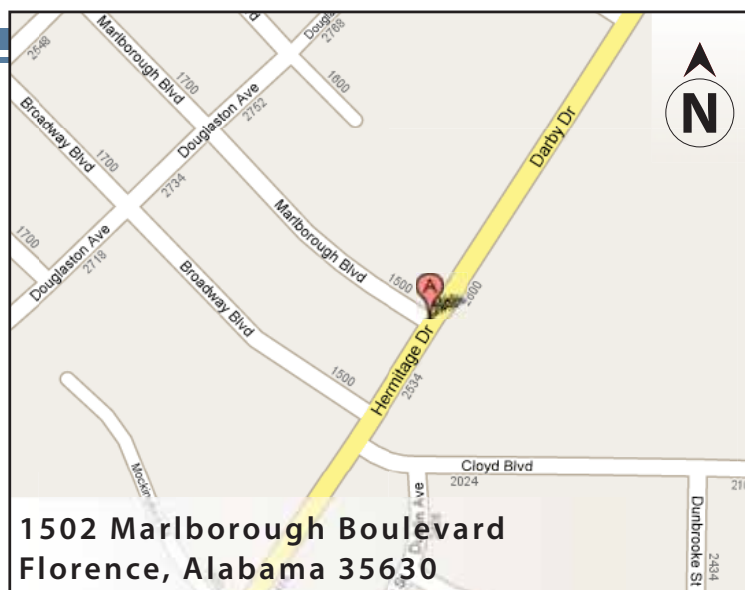

### CONVENIENT NEIGHBORHOOD LOCATION

- Grocery stores, shopping & restaurants
- Banking Services
- Hospitals, medical & professional clinics
- Churches

For more information or to request a housing application, please call

- toll-free 1-800-466-7722
- tty/tdd 1-800-627-3529

Apply online [www.accessiblespace.org](http://www.accessiblespace.org)

Accessible Space, Inc. (ASI)

2550 University Avenue West, Suite 330 North  
Saint Paul, Minnesota 55114

