



# Accessible Space, Inc.

2550 University Avenue West, Suite 330 N | St. Paul, Minnesota 55114

## OUR MISSION HOUSING WITH CARE

The mission of Accessible Space, Inc. (ASI) is to provide accessible, affordable, assisted, supportive and independent living opportunities for persons with physical disabilities and brain injuries as well as seniors. This mission is accomplished through the development and cost-effective management of accessible, affordable housing, assisted/supportive/independent living and rehabilitation services.

## ACKNOWLEDGEMENTS FUNDING AND SUPPORT

Accessible Space, Inc. (ASI) gratefully acknowledges the following organizations for their funding and/or support:

The U.S. Department of Housing and Urban Development (HUD); Minnesota Housing Finance Agency (MHFA) Greater Minnesota Housing Fund; Federal Home Loan Bank of Des Moines Affordable Housing Program/U.S. Bank; City of Rochester Community Development Block Grant Program; Rochester Area Foundation; United Way of Olmsted County; and Olmsted County Department of Human Services. Michael J. Bjerkesett, Development Consultant.



Committed to the success of equal housing opportunities throughout the nation

ASI

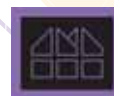

Accessible Space, Inc. (ASI):  
Sponsor, Developer and  
Management Agent

## BOSTROM TERRACE ROCHESTER, MINNESOTA

***Accessible, Affordable Apartments For  
Adults With Qualifying Disabilities***

1680 Eastwood Road Southeast  
Rochester, Minnesota 55904



**Accessible Space, Inc.**

HOUSING WITH CARE



# AccessibleSpace, Inc.

## BOSTROM TERRACE ROCHESTER, MINNESOTA

*Accessible, Affordable Apartments For Adults With Qualifying Disabilities*

### AFFORDABLE

- Qualifying households pay 30% of adjusted gross monthly income for rent
- Rent is subsidized by the U.S. Department of Housing and Urban Development (HUD)-Income limits apply
- Rent includes: Heat, water, sewer, trash & snow removal

### BASIC QUALIFICATIONS

- One household member must have a qualifying disability
- Applicants are screened for credit, rental and criminal history
- Households must be income qualified (income limits apply and security deposit required)

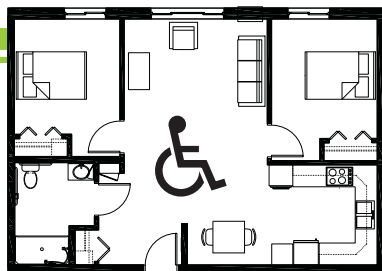

### APARTMENT FEATURES

- 15 accessible, one and two bedroom apartments
- Wheelchair accessible, spacious kitchen
- Large, accessible bathroom with roll-in shower
- Generous closet & storage space
- Carpeted bedroom & living room

### BUILDING FEATURES

- Large, open entry & lobby
- Controlled access entry system
- Outdoor patio with gas grill
- On-site laundry facilities
- Elevator service
- Approved pets welcome!

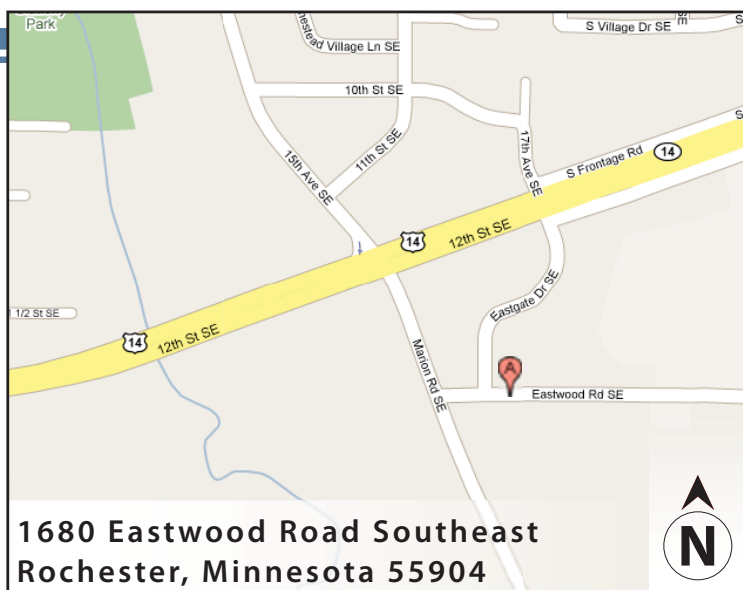

### CONVENIENT NEIGHBORHOOD LOCATION

- Grocery stores, shopping & restaurants
- Banking Services
- Hospitals, medical & professional clinics
- Churches

**For more information or to request a housing application, please call**

- toll-free 1-800-466-7722
- tty/tdd 1-800-627-3529

**Apply online** [www.accessiblespace.org](http://www.accessiblespace.org)

**Accessible Space, Inc. (ASI)**

2550 University Avenue West, Suite 330 North  
Saint Paul, Minnesota 55114

